



**PEARSON
REALTY**
AGRICULTURAL PROPERTIES
A Tradition in Trust Since 1919

FOR SALE

Prime Hanford Farmland



**88.9± Acres Hanford
Kings County, California**

- Class I Prime Soils
- Two Irrigation Wells
- Income
- Location to Future Urban Growth

**Exclusively Presented By:
Pearson Realty**



CALIFORNIA'S LARGEST AG BROKERAGE FIRM

www.pearsonrealty.com
CA BRE #00020875



Prime Hanford Farmland

88.9± Acres

\$2,089,000

DESCRIPTION:

This 88.9± acre prime agricultural property includes; two irrigation wells, irrigation pipeline distribution system, 20± acres of old walnuts, rental income and future urban development growth. The property is surrounded by similar farmland and a residential subdivisions under development to the east and south.

LOCATION:

The property is located south of Hanford Armona Road, ¼ mile west of 12th Avenue adjacent to the City of Hanford. 30 miles south of Fresno and 18 miles west of Visalia, California. In the heart of the San Joaquin Valley.

**ZONING
& LEGAL:**

The property is currently zoned agricultural uses. The Hanford General Plan establishes a future development to low density residential (LD) use. The current zoning is AL-10 (10 acre minimum parcels size). There are three accessed parcels including APN 011-040-008 (18.85± acres), 010 (50.53± acres) and 027 (19.52± acres). The properties will be removed from the Williamson Act Tax Preserve in 2022. Seller granted city sewer truck line from Hanford Armona Road to southern residential development property.

SOILS:

Nord complex. Class I designation by USDA soil survey.

WATER:

The property is irrigated from onsite pumps and wells including 40HP above ground electric and 10HP submersible. The irrigation water is conveyed through a subsurface cement pipeline system with valves spaced along the pipeline for flood irrigation to all row field, vegetable seed and orchard crops.

PLANTINGS:

2018 include 80± acres cotton (walnuts are not being farmed).

**BUILDING
IMPROVEMENTS:**

None.

PRICE/TERMS:

\$2,089,000 (\$23,498/ac.).

NOTES:

1. The property is being sold subject to the 2018 farm lease agreement.
2. The pumping equipment on the north well belongs to tenant.
3. Sellers reserve existing mineral, oil and gas rights.



This aerial map shows a large agricultural site of 88.9± acres, outlined in red. The site is divided into sections of cotton and walnuts. Two wells are marked with blue dots, and a pipeline runs along the eastern boundary. The site is bordered by Hanford Armona Rd to the north and a canal to the west. The City of Hanford is visible to the east, with streets like S 12th Ave and S 11th Ave. A north arrow is located in the bottom left corner.

FLINT AVE

FARGO AVE

GRANGEVILLE BLVD

LACEY BLVD

WY 396 - HANFORD ARMONIA RD

HOUSTON AVE

1ST AVE

2ND AVE

3RD AVE

4TH AVE

5TH AVE

6TH AVE

7TH AVE

8TH AVE

9TH AVE

10TH AVE

11TH AVE

12TH AVE

13TH AVE

14TH AVE

15TH AVE

16TH AVE

17TH AVE

18TH AVE

19TH AVE

20TH AVE

21ST AVE

22ND AVE

23RD AVE

24TH AVE

25TH AVE

26TH AVE

27TH AVE

28TH AVE

29TH AVE

30TH AVE

31ST AVE

32ND AVE

33RD AVE

34TH AVE

35TH AVE

36TH AVE

37TH AVE

38TH AVE

39TH AVE

40TH AVE

41ST AVE

42ND AVE

43RD AVE

44TH AVE

45TH AVE

46TH AVE

47TH AVE

48TH AVE

49TH AVE

50TH AVE

51ST AVE

52ND AVE

53RD AVE

54TH AVE

55TH AVE

56TH AVE

57TH AVE

58TH AVE

59TH AVE

60TH AVE

61ST AVE

62ND AVE

63RD AVE

64TH AVE

65TH AVE

66TH AVE

67TH AVE

68TH AVE

69TH AVE

70TH AVE

71ST AVE

72ND AVE

73RD AVE

74TH AVE

75TH AVE

76TH AVE

77TH AVE

78TH AVE

79TH AVE

80TH AVE

81ST AVE

82ND AVE

83RD AVE

84TH AVE

85TH AVE

86TH AVE

87TH AVE

88TH AVE

89TH AVE

90TH AVE

91ST AVE

92ND AVE

93RD AVE

94TH AVE

95TH AVE

96TH AVE

97TH AVE

98TH AVE

99TH AVE

100TH AVE

101ST AVE

102ND AVE

103RD AVE

104TH AVE

105TH AVE

106TH AVE

107TH AVE

108TH AVE

109TH AVE

110TH AVE

111ST AVE

112ND AVE

113RD AVE

114TH AVE

115TH AVE

116TH AVE

117TH AVE

118TH AVE

119TH AVE

120TH AVE

121ST AVE

122ND AVE

123RD AVE

124TH AVE

125TH AVE

126TH AVE

127TH AVE

128TH AVE

129TH AVE

130TH AVE

131ST AVE

132ND AVE

133RD AVE

134TH AVE

135TH AVE

136TH AVE

137TH AVE

138TH AVE

139TH AVE

140TH AVE

141ST AVE

142ND AVE

143RD AVE

144TH AVE

145TH AVE

146TH AVE

147TH AVE

148TH AVE

149TH AVE

150TH AVE

151ST AVE

152ND AVE

153RD AVE

154TH AVE

155TH AVE

156TH AVE

157TH AVE

158TH AVE

159TH AVE

160TH AVE

161ST AVE

162ND AVE

163RD AVE

164TH AVE

165TH AVE

166TH AVE

167TH AVE

168TH AVE

169TH AVE

170TH AVE

171ST AVE

172ND AVE

173RD AVE

174TH AVE

175TH AVE

176TH AVE

177TH AVE

178TH AVE

179TH AVE

180TH AVE

181ST AVE

182ND AVE

183RD AVE

184TH AVE

185TH AVE

186TH AVE

187TH AVE

188TH AVE

189TH AVE

190TH AVE

191ST AVE

192ND AVE

193RD AVE

194TH AVE

195TH AVE

196TH AVE

197TH AVE

198TH AVE

199TH AVE

200TH AVE

201ST AVE

202ND AVE

203RD AVE

204TH AVE

205TH AVE

206TH AVE

207TH AVE

208TH AVE

209TH AVE

210TH AVE

211ST AVE

212ND AVE

213RD AVE

214TH AVE

215TH AVE

216TH AVE

217TH AVE

218TH AVE

219TH AVE

220TH AVE

221ST AVE

222ND AVE

223RD AVE

224TH AVE

225TH AVE

226TH AVE

227TH AVE

228TH AVE

229TH AVE

230TH AVE

231ST AVE

232ND AVE

233RD AVE

234TH AVE

235TH AVE

236TH AVE

237TH AVE

238TH AVE

239TH AVE

240TH AVE

241ST AVE

242ND AVE

243RD AVE

244TH AVE

245TH AVE

246TH AVE

247TH AVE

248TH AVE

249TH AVE

250TH AVE

251ST AVE

252ND AVE

253RD AVE

254TH AVE

255TH AVE

256TH AVE

257TH AVE

258TH AVE

259TH AVE

260TH AVE

261ST AVE

262ND AVE

263RD AVE

264TH AVE

265TH AVE

266TH AVE

267TH AVE

268TH AVE

269TH AVE

270TH AVE

271ST AVE

272ND AVE

273RD AVE

274TH AVE

275TH AVE

276TH AVE

277TH AVE

278TH AVE

279TH AVE

280TH AVE

281ST AVE

282ND AVE

283RD AVE

284TH AVE

285TH AVE

286TH AVE

287TH AVE

288TH AVE

289TH AVE

290TH AVE

291ST AVE

292ND AVE

293RD AVE

294TH AVE

295TH AVE

296TH AVE

297TH AVE

298TH AVE

299TH AVE

300TH AVE

301ST AVE

302ND AVE

303RD AVE

304TH AVE

305TH AVE

306TH AVE

307TH AVE

308TH AVE

309TH AVE

310TH AVE

311ST AVE

312ND AVE

313RD AVE

314TH AVE

315TH AVE

316TH AVE

317TH AVE

318TH AVE

319TH AVE

320TH AVE

321ST AVE

322ND AVE

323RD AVE

324TH AVE

325TH AVE

326TH AVE

327TH AVE

328TH AVE

329TH AVE

330TH AVE

331ST AVE

332ND AVE

333RD AVE

334TH AVE

335TH AVE

336TH AVE

337TH AVE

[illegible]

LOCATION MAP

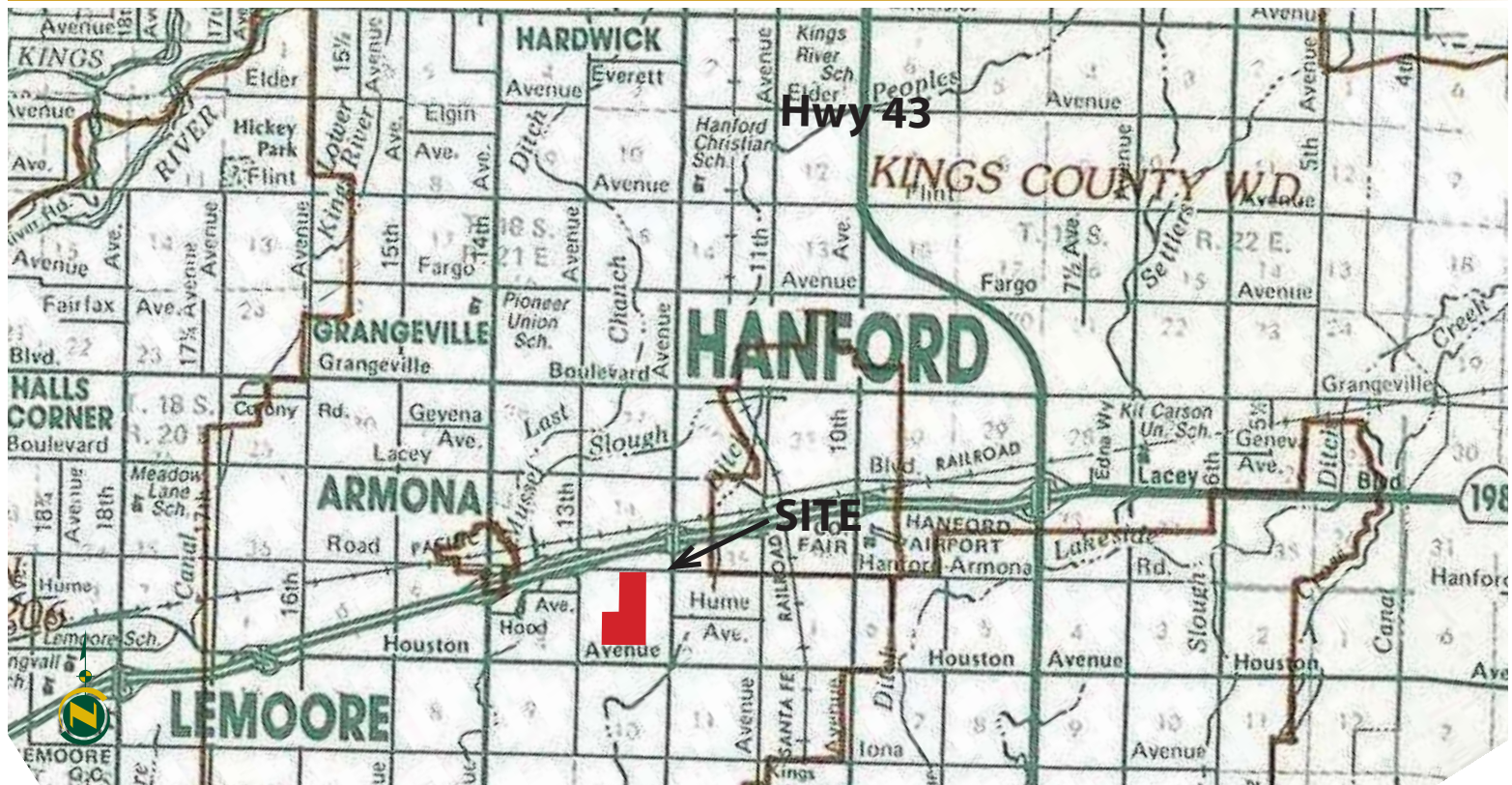

REGIONAL MAP



Offices Serving The Central Valley

FRESNO

7480 N. Palm Ave, Ste 101
Fresno, CA 93711
559.432.6200

VISALIA

3447 S. Demaree Street
Visalia, CA 93277
559.732.7300

BAKERSFIELD

1801 Oak Street, Ste 159
Bakersfield, CA 93301
661.334.2777



**PEARSON
REALTY**

AGRICULTURAL PROPERTIES
A Tradition in Trust Since 1919

We believe the information contained herein to be correct. It is obtained from sources which we regard as reliable, but we assume no liability for errors or omissions. Policy on cooperation: All real estate licensees are invited to offer this property to prospective buyers. Do not offer to other agents without prior approval.

